

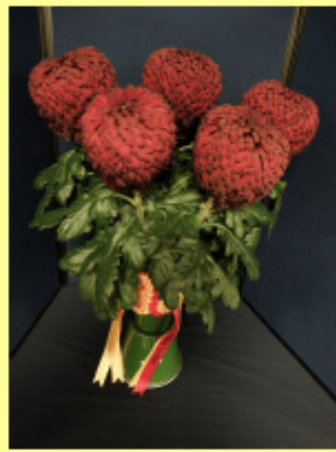

Best Large Exhibition in Show
Grown by Andy Wickham



Best Medium Reflex in Show
Doreen Statham Grown by
Steve & Stella Joyce



**NATIONAL CHRYSANTHEMUM
SOCIETY
2017 SHOW SCHEDULE**



EARLY CHRYSANTHEMUM SHOW
SATURDAY and SUNDAY
9th and 10th SEPTEMBER 2017

**BINGLEY HALL,
COUNTY SHOWGROUND, STAFFORD**

LATE CHRYSANTHEMUM SHOW
FRIDAY & SATURDAY
3rd and 4th NOVEMBER 2017

**PRESTWOOD CENTRE,
COUNTY SHOWGROUND, STAFFORD**

Early National in Bingley Hall

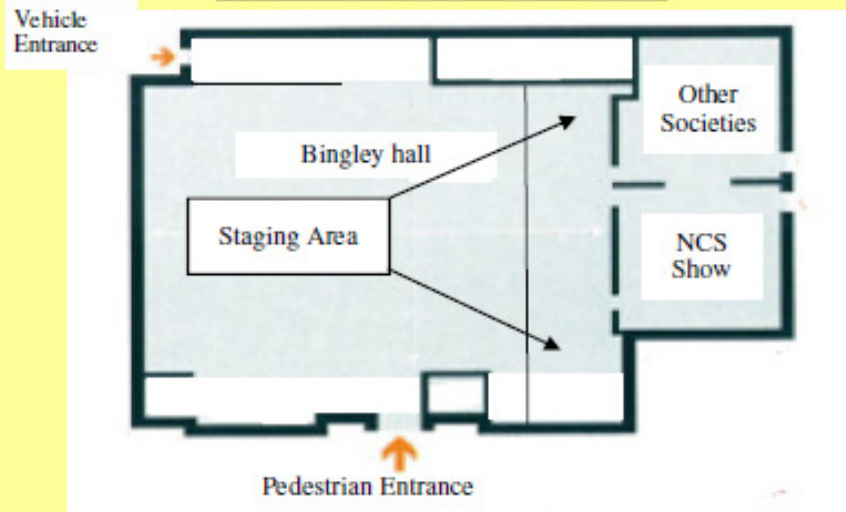

SHOW MANAGER

Terry Porter, Wood View, 15a Moorcroft Road, Hutton
Weston-super-Mare, North Somerset. BS24 9RW

Tel 01934 813399 Mob 07989 855339

E Mail taporter11@aol.com

NCS Web Site - nationalchrysanthemumsociety.co.uk



**THE EXHIBITION OF
EARLY CHRYSANTHEMUMS**
BINGLEY HALL, COUNTY SHOWGROUND

Stafford on

SATURDAY and SUNDAY
9th and 10th SEPTEMBER 2017

Open from 12.00 noon to 5.00 pm on 9th September, and from
10.00 am to 3.00 pm on 10th September
Other parts of the show open at 11.00 am. on
Saturday 9th September

ENTRIES CLOSE ON SUNDAY 3rd SEPTEMBER 2017

PRESENTATION OF TROPHIES

2.30 pm on SATURDAY 9th SEPTEMBER

★

**THE EXHIBITION OF
LATE CHRYSANTHEMUMS**

PRESTWOOD CENTRE, COUNTY SHOWGROUND

Stafford on

FRIDAY & SATURDAY
3rd & 4th NOVEMBER 2017

Open from 12.00 noon to 5.00 pm on 3rd November and from
10.00 am to 3.00 pm on 4th November

ENTRIES CLOSE ON SUNDAY 29th OCTOBER 2017

PRESENTATION OF TROPHIES

2.30 pm on SATURDAY 3rd November

Web Site www.nationalchrysanthemumsociety.co.uk



Derek Bircumshaw Trophy Winners Steve & Stella Joyce



Bob Dawsey Trophy Winners John & Allyson Peace

Top Right Best Medium Intermediate & Best vase in Show, Rita Fox
grown by John & Allyson Peace.

NOVEMBER SHOW

- 88 **One Vase of Intermediate Chrysanthemums. Large and/or Medium and/or Small flowered. (Section 5).**
Any cultivar or cultivars, disbudded, three blooms.
89. **One Vase of Anemone Chrysanthemums, Large and/or Medium and/or Small flowered. (Section 6).**
Any cultivar or cultivars, disbudded, three blooms.
90. **One Vase of Singles, Large and/or Medium, and/or Small flowered. (Section 7).**
Any cultivar or cultivars, disbudded, three blooms.
91. **One Vase of Late Spray Chrysanthemums. (Spray forms of Section 8 and/or 9).**
Three 'Natural' or 'Exhibition' sprays, any cultivar or cultivars.
92. **One Vase of Late Chrysanthemums from Section 3 and/or 4 and/or 5.**
Three blooms disbudded, any cultivar or cultivars. Eligible as previous class

OLD CULTIVAR CLASS.

OLD CULTIVAR TROPHY

Holder: Not Awarded

93. **Three Vases, three blooms per vase from Section 3 and/or 4 and/or 5.**
Any cultivars. Cultivars eligible– those registered before 1975 and not exhibited at National Shows in the past five years. Also eligible – Beacon, Fair Lady & Sports, Purple Glow and Sports, Balcombe Perfection and sports. **Trophy & Silver medal.**

INDIVIDUAL SINGLE BLOOM CHAMPIONSHIP

Red Ken Trophy

Holder : Steve & Stella Joyce

- 94 **Six vases, one bloom per vase.**
Each vase to hold one bloom from sections 3, 4, 5, 6, 7 or 9 . Six distinct cultivars, from a minimum 3 sections. Maximum two blooms from any family, ie sports
Trophy, Silver Medal

SINGLE BLOOM TROPHY

Holder : Teifryn Pugh

- 95 **Six vases, one bloom per vase.**
From sections 3, 4, 5, 6, 7 or 9 . Any cultivar or cultivars
Trophy, Silver Medal

TRAVELLERS CLASS

Entries in these classes will be accepted up to 9.30 am on morning of show. Obtain the appropriate class cards from the show manager. More than one entry allowed.

- 96 **One Vase of Late Spray Chrysanthemums. (Section 9).**
Three 'Natural' or 'Exhibition' sprays, any cultivar or cultivars.
97. **One Vase of Late Chrysanthemums.**
Five blooms disbudded, any cultivar or cultivars.

SPONSORSHIP FOR THE 2017 SHOWS

The Officers and Committee of the National Chrysanthemum Society are grateful to the Patrons, Fellows, Members, Affiliated Societies and Trade Firms who have kindly provided support for the Early and Late National shows.

Thanks are due to **Stafford Borough Council** for their grant towards staging the Early Show at Stafford..

Our thanks must also go to the many members and friends who so willingly give their time and effort in supporting and working so hard to ensure the success of our two shows. If we named them, we would probably forget someone, so a very sincere and warm thank you to you all.

SHOW REGULATIONS 2017

These Regulations apply to the Early and Late N.C.S. Shows and should be read in conjunction with the Show Regulations and Rules for Judging which are set out in the current N.C.S. publication 'Chrysanthemum Judging and Exhibiting' and apply to all Shows judged under N.C.S. Rules.

- 1. Entry Forms.** Persons wishing to exhibit at the Society's Shows must complete and send the entry form enclosed to the Show Manager not later than Sunday 3rd September, in respect of the Early Show and not later than Sunday 29th October for the Late show.
All exhibits must have been grown by the exhibitor for three months previous to the date of the show, and a certificate to that effect must be signed on the entry form.
No exhibitor may make more than one entry in any one class, with the exception of classes 12 to 14, 70, 71 in the Early show, and classes 11 to 13, 69, 70, 71, 96 and 97 in the Late show.
- 2. Entry Fees: NONE.**
Persons not members of the Society must become members in order to exhibit.
- 3. Withdrawals.** Exhibitors wishing to withdraw from trophy classes are requested to notify the Show Manager by 9 am on the day previous to the Show. **This will help in the show layout.**
- 4. Conditions of Acceptance of Entries.** Entries are accepted on the distinct understanding that the exhibits remain staged during the whole time the exhibition is open. **Any removal before that time can be carried out only with the consent of the Show Manager and** in the presence of the Show Manager or of a person deputed to act on his behalf.
The Show Manager or Show Secretary (if appointed) shall have the power to reject any exhibits considered not worthy of exhibition.
- 5. Non-Competitive Exhibits** are invited and discretionary awards may be made to non-competitive exhibits.
- 6. Staging: ONLY ONE BASE PER VASE IS PERMITTED – MORE THAN ONE AND THE EXHIBIT WILL BE DISQUALIFIED.** A selection of staging blocks are available from the Show Manager. **ONLY LARGE/MEDIUM EXHIBITION OR FANTASIES ARE TO BE STAGED IN SINGLE BLOOM VASES. Time for Staging of Exhibits.** The Exhibition Hall will be open from 2.00 pm on the day prior to the Shows and will remain open all night for staging of exhibits. Staging of Competitive exhibits must be completed by **10.00 am on the first day of both the Early and Late Shows.** Vases will be provided. All possible care will be taken of exhibits, but any remaining after the advertised time of closing of the show must be at the owner's risk. No flowers shall have their position altered or be removed from the stands after having been staged, except with the sanction of the Show Manager or Show Secretary. Exhibitors must leave the Exhibition Hall at **10.00 am on the first day of both the Early and Late Shows**, unless officially retained by the Show Manager. **No vases are to be moved after this time.**
- 7. Exhibitors' Entry Cards and Name Cards.** Cards will be available in the staging area. Cards to be placed (reversed) in front of their exhibits before judging. Any exhibits left without a card will be considered as not for competition. It is important that the correct name of a cultivar and not abbreviated versions are used when naming cultivars
Every cultivar should be correctly labelled - groups and exhibits arranged for decorative effect are excepted. Name cards upon which the names of the blooms must be legibly written, are provided, and should be placed in front of each vase. Seedling entries must show only classification and colour until after judging when the name can be Displayed.

8. **Judging** will be conducted under the current N.C.S. Code of Rules for Judging. The Shows Committee may award extra prizes at their discretion.
9. **Protests and objections.** The decision of the Judges as regards the relative merits of Chrysanthemum exhibits is final; and no protest on those grounds can be entertained.
Any protests on other grounds regarding the awards of the Judges (e.g. the interpretation of the schedule, or the qualification of an exhibitor) should be made to the Show Manager within 1 hour of the official opening of the show. Protests will be dealt with by the Shows Committee, which shall have power to declare any exhibit in any class disqualified on protest, and this decision shall be final. Disputed questions of nomenclature which the Show Committee is unable to decide shall be referred to the Floral Committee, and its decisions shall be final.
10. **Liability for Loss.** All exhibits, personal property, etc., shall be at the risk of the exhibitors, and the Society shall not be liable for compensation for loss or damage by theft, fire, water, accident, or any other cause whatsoever. Should a show not be held from any cause, no exhibitor shall have any claim on the Society or its Officers for loss, damage, interest, or compensation. Exhibitors shall be wholly responsible for any claim made by their employees under the Employer's Liability Acts or the Workmen's Compensation Act, and amending and supplementary Acts. The Society shall not be responsible for any accident arising from any cause whatsoever to any person visiting the Shows, or for any damage or loss, how ever caused, to the property of any such person.
11. **SPECIAL NOTICE TO JUDGES, SECRETARIES OF AFFILIATED SOCIETIES AND PERSONS CONCERNED WITH THE ADJUDICATION OF SPECIAL AWARDS AT CHRYSANTHEMUM SHOWS.**
Once a vase of blooms has been staged by an exhibitor under a section other than that in which the cultivar concerned is classified, such blooms must remain in the classification section in which they are staged for the duration of the show. An intermediate shown in two forms in an entry constitutes only one cultivar.
For example, where intermediates are exhibited in a class for Incurved blooms, or in a class for Reflexed blooms, they will be judged as Incurved or Reflexed, as the case may be, for the purposes of the class in which they are staged and for such consideration as Best Vase of Incurved or Reflexed. They will not be eligible for such awards as Best Vase of Intermediates.
AFFILIATED SOCIETY EXHIBITS. When considering an award for the Best Vase of blooms in the show, exhibits staged by a member or members of an Affiliated Society are eligible.
12. Trophies will be awarded only to the first prize exhibits, except where otherwise stated. All Cups, Trophies, etc. are to be held by the winner for one year and must be returned to the Show Manager prior to the following year's Show.
13. Cultivars classified as Pompons in Sections 8, 18 and 28 may be exhibited in spray form where classes call for sprays, as follows: cultivars in Section 8 may be exhibited in classes for Section 9; cultivars in Section 18 in classes for Sections 19 and 29, cultivars in Section 28 in classes for Section 29.
14. The following conditions apply to Affiliated Chrysanthemum and Horticultural Societies only in the following classes.
At the Early Show: (i) Affiliated Societies Championship of Great Britain, Class 1
(ii) Affiliated Societies Roy Calladine Memorial Trophy, Class 2
(iii) The 'Amateur Gardening' Challenge Shield, Classes 3, 4, 5, 6, 7, 8 and 9
(iv) Class 10. The Stoke Festival Trophy
(v) Class 11 Provincial group class
At the Late show: (i) Classes 1 to 10
- The entry is made in the name of the Society through one of its officers, thus. Exhibited by
"....." Society.
 - Societies competing must guarantee that the blooms have been cut from the collections of its members only.
- Silver medals are now to be awarded to winning Societies in classes 1,2 & 11 at the Early show, and classes 1,2 & 3 of the Late Shows. The winning Society, if they contact the show manager can claim a Silver medal for all those members that contributed to their winning exhibit.

NOVEMBER SHOW

THE FANTASY CUP

Holder: Brian Sidebottom

78

Three Fantasies. (Section 10).

Three blooms to be shown in three vases, any cultivar or cultivars.

Cup, Silver Medal.

The following classes are for those who employ no paid assistance in the culture of their Chrysanthemums and grow not more than 50 Late flowering plants (excluding Sprays).

79. Three Vases of Late Chrysanthemums, Large and/or Medium flowered. (Section 3, and/or 4, and/or 5, and/or 6, and/or 7).

Three distinct cultivars, disbudded, three blooms of one cultivar in each vase.

80 One Vase of Late Chrysanthemums, Large and/or Medium flowered. (Section 3, or 4 or 5 or 6 or 7).

Disbudded, five blooms of one cultivar.

81. One Large Exhibition or one Medium Exhibition Bloom. (Section 1 or 2).

Any cultivar.

82. One Vase containing three blooms Incurved, (Section 3) or three blooms Reflexed, (Section 4) or three blooms Intermediate, (Section 5) or three blooms Anemone (Section 6) or three blooms Single, (Section 7). , One cultivar.

Class 83 is restricted to those who have not previously won a first prize in a multi-vase class at the Late Show of the National Chrysanthemum Society. See Rule 20

83. THE GEORGE WILSON MEMORIAL TROPHY

Presented by Mrs G. Wilson

Holder: Not awarded

Five Vases of Chrysanthemums from the following sections: one cultivar in each vase
Five different sections must be shown.

One bloom from section 1 or 2

One bloom Fantasy (Section 10)

One vase of three blooms Incurved (Section 3), disbudded

One vase of three blooms Reflexed (Section 4), disbudded

One vase of three blooms Intermediate (Section 5), disbudded

One vase of three blooms Anemone (Section 6), disbudded

One vase of three blooms Singles (Section 7), disbudded

One vase of three stems of sprays (Section 9)

Trophy, Silver Medal

Classes 84 to 92 are restricted to those who have not previously won a first prize at the Late show of the National Chrysanthemum Society.

84 Three Large and/or Medium Exhibition Blooms. (Section 1 and/or 2).

Three vases, one bloom in each vase, any cultivar or cultivars.

85. One Large or Medium Exhibition Bloom. (Section 1 or 2).

Any cultivar.

86. One Vase of Incurved Chrysanthemums. Large and/or Medium and/or Small flowered. (Section 3).

Any cultivar or cultivars, disbudded, three blooms.

87. One Vase of Reflexed Chrysanthemums. Large and/or Medium and/or Small flowered. (Section 4).

Any cultivar or cultivars, disbudded, three blooms.

NOVEMBER SHOW

DWARF POT CHRYSANTHEMUMS

To Include Boulou Types
Sylvia and Martyn Silver Salver
Holder Not Awarded

72.

Three pots Dwarf Pot Chrysanthemums.

Any cultivar or cultivars.

1 plant per pot, max pot size 4 litre. Minimum 25mm stem above soil.

Salver, Silver medal

73. **One pot Dwarf Pot Chrysanthemums.**

Any cultivar .

1 plant per pot, max pot size 4 litre. Minimum 25mm stem above soil.

FANTASIES

Unobtrusive supports and rings may be used not exceeding 180 mm diam

74.

The Member winning this class will be acknowledged the
“NATIONAL CHAMPION FOR LATE FANTASY CHRYSANTHEMUMS”
and will be awarded:

THE AMBERWAY SALVER

Presented by Wallace Farr

Holders: Dave & Val Thorrington

Fifteen Fantasies. (Section 10).

Fifteen blooms to be shown in fifteen vases, not less than five distinct cultivars, or more than six blooms of any one cultivar

Salver, Solid Silver Medal

75.

THE TROPHY

Presented Anonymously

Holder: Dave & Val Thorrington

Nine Fantasies. (Section 10).

Nine blooms to be shown in nine vases, not less than four distinct cultivars.

Trophy, Silver Medal

76.

THE ALF RAYBOULD SILVER CHALLENGE CUP

Presented by Stourbridge Chrysanthemum & Dahlia Society

Holder: Dave & Val Thorrington

Six Fantasies. (Section 10).

Six blooms to be shown in six vases, not less than two distinct cultivars.

Cup, Silver Medal.

77.

THE MEDIUM FANTASY TROPHY

Presented by National Chrysanthemum Society

Holder: Brian Sidebottom

Six Fantasies. (Section 10c/2).

Six blooms to be shown in six vases, not less than two distinct cultivars.

Cup, Silver Medal

(Cultivars available for this class include Winsome, Downpour, Alabama, Fireworks, Golden Rain, Kimie, Oregon city, Lava, Tu Tu, Seatons Galaxy & Salhouse Dream)

15. AFFILIATED SOCIETY LEAGUE CLASS

This class will be judged under the following rules.

1) The BEST bloom is selected from a row, e.g. the front row, this bloom is pointed out of a 100.

2) The other blooms on the row are put in order 2nd, 3rd, 4th etc and points given accordingly.

3) The BEST bloom on the middle row is pointed bearing in mind the points allocated to the best bloom and other Blooms on the first row. The remainder in this row are pointed accordingly.

4) The BEST bloom on the remaining row is pointed, bearing in mind the points allocated to the blooms on the other two rows. The remaining blooms in this row are then pointed.

The points will be recorded by the judges on the specially designed exhibitors cards and transferred to the front of the Cards by the steward to correspond with the details of cultivars and growers, supplied by the exhibiting society.

16. **Deceit/Malpractice** - Where a person is found to be in breach of Show Regulations by deliberate deception or/and malpractice at National Shows, all his/her exhibits will be excluded from the Show. Such deception/malpractice will render the exhibitor banned from National Shows for a minimum period of two subsequent years. A quorum of the Management Committee will make the decision on the day of the Show; the exhibitor will have a right of appeal to the Executive Committee.

17 Fourth Prize Awards

Fourth Prizes will be awarded in all Medal and Trophy classes.

EARLY SHOW CLASSES

1, 2, 10, 11, 12, 13, 15, 16, 17, 21, 22, 23, 24, 29, 30, 31, 32, 33, 34, 35, 36, 37, 38, 39, 40, 41, 42, 50, 51, 56, 66, 68, 69

LATE SHOW CLASSES

1, 2, 3, 9, 10, 11, 12, 14, 15, 16, 17, 18, 20, 21, 22, 23, 24, 26, 27, 28, 29, 30, 31, 35, 36, 37, 38, 39, 40, 45, 46,

49, 50, 53, 54, 55, 56, 57, 58, 59, 61, 68, 69, 70, 72, 74, 75, 76, 77, 78, 83, 92, 93, 94, 95

18 **Fantasies** Unobtrusive supports and rings may be used when exhibiting fantasies, they should not exceed 7" diameter.

19 Best vases will be placed back in their exhibits until 10.30 am on the second morning of the show so that pictures can be taken.

20 At either of the shows, winning the individual six bloom Individual Bloom class will not prevent the exhibitor entering in the restricted multi vase class, The Thistlewaite in the Early and the George Wilson in the Late show.

21 **Hot water for drinks is available during staging, but Food may not be available all night.**

Changes to NCS Rule for Cultivars under review..

The NCS Executive committee changed the rules for cultivars under review. Taking effect in all of the shows under NCS rules throughout the UK any cultivar under review will be eligible to be exhibited not only in its Existing Classification, **BUT ALSO** its classification that is under review.

For example a cultivar registered Large (a) that is under review to be shown as a Medium (b) can be exhibited in either of these sections.

Cultivars under review in 2017 include

Ted Stepney	25a	Proposed change to 15b
Courtier	24a	Proposed change to 24b
Red Formcast	24a	proposed change to 24b
Ann Dickson	25a	Proposed change to 25b
Rosedew	25a	Proposed change to 25b
Seatons Galaxy	10a/2	Proposed change to 10a
Tutu	10a	Proposed change to 10a/2

If you wish a cultivar to be judged in its proposed classification this will need to be marked on vase of chrysanthemums.

CHRYSANTHEMUM GROWERS OF THE YEAR COMPETITION

The competition to find the National Chrysanthemum Society's 'Chrysanthemum Growers of the Year' will be based on exhibits staged at the Early and Late National Shows, respectively.

At the Early Show, first prize exhibits in classes 15 - 55 including second and third prize exhibits in multi-vase classes, and the Late Show, classes 14 - 82 including second and third prize exhibits in multi-vase classes, will be awarded points based on the requirements of the class. Points are awarded: -

Early Show - each winning vase of 5 blooms carries 2 points. Five vases of 3 blooms equals 3 vases of 5 blooms.

Late Show - All winning large and medium Exhibition blooms carry 1 point. Each winning vase of 5 blooms carries 3 points. Five vases of 3 blooms equals 3 vases of 5 blooms. Winning vases of 3 sprays carry 2 points and single stems 1 point. Winning Charms and Specimen plants carry 6 points, second and third prize exhibits in these classes carry 3 and 1½ points respectively.

Both Shows - Second prize winners in Multi-Vase classes carry half the points awarded to the winner and third prize winners a quarter.

Bonus points are awarded to the Bentley Trophy winner (6 points) and Best Vases in Show (4 points).

At each show the top five points winners will be considered for grower of the year. A small panel of growers will select the Grower of the Year from these five candidates presented to them. This will allow all factors relative to the award to be considered.

NATIONAL CHRYSANTHEMUM SOCIETY THE EXHIBITION OF

EARLY CHRYSANTHEMUMS

SPECIAL AWARDS

The Bentley Trophy – Holder: John & Allyson Peace - and a Solid Silver Medal will be awarded to the exhibit of most merit in the show, together with a cut glass trophy .

The Flo Cooper Trophy – Holder: John & Allyson Peace– will be awarded for the best vase of blooms in the Show.

The Brian Ramsdale Memorial Trophy - will be awarded to the best vase of Medium Flowered reflex blooms in the show. Holder: Jim Vickerman

A Solid Silver Medal will be awarded for the best vase of Incurved blooms in the Show.

A Solid Silver Medal will be awarded for the best vase of Large- flowered Reflexed blooms in the Show.

A Solid Silver Medal will be awarded for the best vase of Medium-flowered Reflexed blooms in the Show.

A Solid Silver Medal will be awarded for the best vase of Large-flowered Intermediate blooms in the Show.

A Solid Silver Medal will be awarded for the best vase of Medium-flowered Intermediate blooms in the Show.

Spray Awards

There will be a best vase of Sprays chosen from sub-sections (a) or (f).

There will be a best vase of Sprays chosen from sub-sections (d).

There will be a best vase of Sprays chosen from sub-sections (b), (c) or (e).

The overall best vase of Sprays will be awarded the Philip Rowe Solid Silver Medal, the other vases will be awarded a N.C.S. Solid Silver Medal.

The 'Amateur Gardening' Challenge Shield presented to the Society by the Proprietor of 'Amateur Gardening' will be awarded to the Society gaining the highest total points in classes 3, 4, 5, 6, 7, 8 and 9. The title of the winning Society will be engraved each year on the Trophy.

Holder: Stoke on Trent Society

NOVEMBER SHOW

62. EILEEN BARCLAY TROPHY Holder: Not Awarded

Three Vases of Late Spray Chrysanthemums. (Section 9).

Three distinct cultivars, three 'Exhibition' sprays, and/or 'Natural' sprays per vase, one cultivar in each vase.

Trophy, Silver Medal

63. Three Vases of Late Spray Chrysanthemums. (Section 9).

Each vase to contain one 'Exhibition' spray only, any cultivar or cultivars.

64. Three Vases of Late Double Spray Chrysanthemums. (Section 9, sub-sections b, c, e).

Three distinct cultivars, three 'Exhibition' sprays of one cultivar in each vase.

65. Three Vases of Late Single Spray Chrysanthemums. (Section 9, sub-sections a, d, f).

Three distinct cultivars, three 'Exhibition' sprays of one cultivar in each vase.

66. One Vase Late Double Spray Chrysanthemums. (Section 9, sub-sections b, c, e).

Three 'Exhibition' sprays, any cultivar or cultivars.

67. One Vase Late Single Spray Chrysanthemums. (Section 9, sub-sections a, d, f).

Three 'Exhibition' sprays, any cultivar or cultivars.

68. One Vase of Late Spray Chrysanthemums. (Section 9).

Three 'Natural' or 'Exhibition' sprays, any cultivar or cultivars.

SPECIMEN PLANTS

More than one entry allowed in class 69

69 THE WRIGHT CHALLENGE CUP Holder: Not Awarded

One Specimen Chrysanthemum Plant (in bloom) in any container

Any size allowed.

Cup, Silver Medal

CHARMS, CASCADES AND CUSHION MUMS

More than one entry allowed in classes 70 & 71

70 THE BILL COUCHMAN MEMORIAL TROPHY Presented by Mrs & Mrs Barry Jackman Best Exhibit class 70 or 71 Holder: Phillip Sutcliffe

One Charm Chrysanthemum Plant or Pot of Cushion Mums (in bloom) in a pot.

Any size pot allowed.

Silver Medal

71. One Cascade, standard or other Chrysanthemum Plant.

Any size pot allowed.

Silver Medal

56.

NOVEMBER SHOW

THE MIXED TROPHY

Holder: David Searles

Five Vases of Late Chrysanthemums. (Section 3 &/or 4, &/or 5, &/or 6, &/or 7).

Five distinct cultivars, disbudded, three blooms of one cultivar in each vase. Minimum of three sections, no more than two from one section.

Trophy, Silver Medal

ANEMONE

57.

**The Member winning this class will be acknowledged
“NATIONAL CHAMPION FOR LATE ANEMONE CHRYSANTHEMUMS”**

and will be awarded

THE CORONATION BOWL

Holder: Mike Shepherd

Five Vases of Anemone Chrysanthemums. (Sections 6).

Five distinct cultivars, disbudded, five blooms of one cultivar in each vase.

Bowl, Solid Silver Medal

58.

ANNIVERSARY CHALLENGE TROPHY

Presented by Weston Chrysanthemum Society

Holder: Mike Shepherd

Three Vases of Anemone Chrysanthemums. (Section 6).

Three distinct cultivars, disbudded, five blooms of one cultivar in each vase.

Trophy, Silver Medal

59

WOOLMANS CENTENARY ANEMONE TROPHY

Holder: Mike Shepherd

Five Vases of Anemone Chrysanthemums. (Section 6).

Five distinct cultivars, disbudded, three blooms of one cultivar in each vase.

Trophy, Silver Medal

60 **One Vase of Anemone Chrysanthemums. (Section 6).**

Any cultivar or cultivars, disbudded, five blooms.

SPRAY CHRYSANTHEMUMS

61.

**The Member winning this class will be acknowledged
“NATIONAL CHAMPION FOR LATE SPRAY CHRYSANTHEMUMS”**

and will be awarded:

THE FRANK ROWE CHALLENGE TROPHY

Presented by Frank Rowe

Holder: Chris Webber

Six Vases of Late Spray Chrysanthemums. (Section 9). Six distinct cultivars, three ‘Exhibition’ sprays per vase, one cultivar in each vase.

Trophy, Solid Silver Medal

SEPTEMBER SHOW

AFFILIATED SOCIETY CLASSES

1.

AFFILIATED SOCIETIES’ CHAMPIONSHIP OF GREAT BRITAIN

The winner of this class will be acknowledged

NATIONAL CHRYSANTHEMUM SOCIETY AFFILIATED SOCIETIES CHAMPION

Holder: Stoke on Trent C & D Society

Nine Vases of Early Chrysanthemums. (Section 23, and/or 24, and/or 25, and/or 29).

Nine distinct cultivars, five blooms/sprays of one cultivar in each vase.

Large and/or Medium and/or Small flowered.

Trophy, Silver Medals

2.

THE ROY CALLADINE MEMORIAL TROPHY

Holder: Denton & District C & D Society

Six Vases of Early Chrysanthemums. (Section 23, and/or 24, and/or 25, and/or 29).

Six distinct cultivars, three blooms/sprays of one cultivar in each vase.

Large, and/or Medium and/or Small flowered.

Trophy, Silver Medals

Class 1 & 2: See rule 14 re Additional Silver medals.

‘AMATEUR GARDENING’ CHALLENGE SHIELD

Classes 3 to 9

Holder: Stoke on Trent Society

Points are allocated in these classes on the same basis as the growers of the Year award.

3.

Five Vases of Early Chrysanthemums. (Section 23, and/or 24, and/or 25).

Large and/or Medium, and/or Small-flowered, five distinct cultivars, disbudded, five blooms of one cultivar in each vase.

4.

Three Vases of Early Chrysanthemums. (Section 23, and/or 24, and/or 25).

Large flowered, three distinct cultivars, disbudded, five blooms of one cultivar in each vase.

5.

One Vase of Early Chrysanthemums. (Sections 23, 24 or 25).

Large flowered, one cultivar only, disbudded, five blooms.

6.

Three Vases of Early Chrysanthemums. (Sections 23, and/or 24, and/or 25).

Medium and/or Small flowered, three distinct cultivars, disbudded, five blooms of one cultivar in each vase.

7.

One Vase of Early Chrysanthemums. (Sections 23, 24 or 25).

Medium or Small flowered, one cultivar only, disbudded, five blooms.

8.

Three Vases of Early Spray Chrysanthemums. (Section 29).

Three distinct cultivars, five ‘Exhibition’ sprays of one cultivar in each vase.

9.

One Vase of Early Spray Chrysanthemums. (Section 29).

Five ‘Exhibition’ sprays, one cultivar only.

SEPTEMBER SHOW

10. **AFFILIATED SOCIETIES' LEAGUE CLASS
THE STOKE FESTIVAL TROPHY**
Holder: South Wilts C & D Society

Back row, 2 blooms, Intermediate.

Middle row, 2 blooms, Reflexed.

Front row, 2 blooms, Incurved.

EACH BLOOM STAGED IN A SEPARATE VASE WITH 660 mm HEIGHT MAXIMUM FROM STAGING TO TOP OF BLOOM. These classes will be judged on a strict points system, each bloom individually pointed **SEE RULE 15**. A rosette will be awarded to the best bloom in each row. If a sufficient number of societies enter, then this class will be divided into

a League 1 and a League 2 in future years, with promotion and relegation.

Trophy

N.C.S. GROUPS

11. **INTER-SOCIETY CHAMPIONSHIP
THE FRANCES AND WALLACE FARR PERPETUAL CHALLENGE TROPHY**

Holder: Stoke on Trent Society

Each N.C.S. Group is invited to nominate two Affiliated Societies to compete as their representatives.

Six Vases of Early Chrysanthemums, comprising three vases of Large- and three vases of Medium flowered. (Section 23, and/or 24, and/or 25).

Six distinct cultivars, disbudded, five blooms of one cultivar in each vase.

Trophy, Silver Medals

RAISERS' CLASSES

Competitive Classes for Seedling Chrysanthemums

SPORTS ARE NOT ELIGIBLE

Classes 12 and 13 are open to all raisers to stage exhibits of cultivars which have been registered and classified and which have not yet been released for sale to the public. There is no limit to the number of entries made by each exhibitor in either class. No exhibitor may stage more than one entry of any cultivar, and no cultivar may win the Trophy more than once.

CHRYSANTHEMUM RAISERS' ASSOCIATION PERPETUAL TROPHY FOR THE BEST EXHIBIT IN CLASSES 12 & 13

Holder: Don Horn

12. **One Vase of Early and/or October Chrysanthemums. (Sections 13 – 18 and 23 – 28).**
Three blooms of one cultivar.

Silver Medal

13. **One Vase of Early Spray Chrysanthemums. (Sections 19 or 29).**
Three Sprays of one cultivar.

Silver Medal

NOVEMBER SHOW

50. **THE CATHEDRAL TROPHY**
Presented by South Wilts Chrysanthemum & Dahlia Society
Holder: Edward Waterson

Three Vases of Singles, Medium flowered. (Section 7).

Three distinct cultivars, disbudded, five blooms of one cultivar in each vase.

Trophy, Silver Medal

51. **Two Vases of Singles. (Section 7).**

One Vase of Large flowered 7a and one Vase of Medium-flowered 7b, five blooms of one cultivar in each vase.

52. **One Vase of Singles, Medium and/or Small flowered. (Section 7).**

Any cultivar or cultivars, disbudded, five blooms.

INCURVED, REFLEXED, INTERMEDIATE & SINGLES

53. **THE LEN SHOESMITH TROPHY**
Presented by Warrington Chrysanthemum & Dahlia Society
Holder: Steve & Stella Joyce

Three Vases of Late-flowering Chrysanthemums.

(Section 3, and/or 4, and/or 5, and/or 6, and/or 7). Minimum of Two Sections
Three distinct cultivars, disbudded, three blooms of one cultivar in each vase.

Trophy, Silver Medal

INDIVIDUAL CLASSES

54. **The Member winning this class will be acknowledged**
“NATIONAL INDIVIDUAL CHAMPION FOR LATE CHRYSANTHEMUMS
THE HARRY JOHNSON PERPETUAL TROPHY

Presented by Messrs. Joseph Bentley

Holder: John Marshall

Five Vases of Chrysanthemums from the following sections: one cultivar in each vase
Five different sections must be shown.

One bloom from section 1 or 2

One bloom Fantasy (Section 10)

One vase of five blooms Incurved (Section 3), disbudded

One vase of five blooms Reflexed (Section 4), disbudded

One vase of five blooms Intermediate (Section 5), disbudded

One vase of five blooms Anemone (Section 6), disbudded

One vase of five blooms Singles (Section 7), disbudded

One vase of three stems of sprays (Section 9)

Trophy, Solid Silver Medal

55. **THE DEREK BIRCUMSHAW TROPHY**
Holder: Steve & Stella Joyce

Five Vases of Late Chrysanthemums. (Section 3 &/or 4, &/or 5, &/or 6, &/or 7).

Five distinct cultivars, disbudded, five blooms of one cultivar in each vase. Minimum of three sections, no more than two from one section.

Trophy, Solid Silver Medal

NOVEMBER SHOW

41. **One Vase of Reflexed Chrysanthemums. Large flowered. (Section 4).**
Any cultivar or cultivars, disbudded five blooms.
42. **One Vase of Intermediate Chrysanthemums. Large flowered. (Section 5).**
Any cultivar or cultivars, disbudded, five blooms.
43. **One Vase of Reflexed Chrysanthemums. Medium or Small flowered. (Section 4).**
Any cultivar or cultivars, disbudded, five blooms.
44. **One Vase of Intermediate Chrysanthemums. Medium or Small flowered. (Section 5).** Any cultivar or cultivars, disbudded, five blooms.

INCURVED AND REFLEXED OR INTERMEDIATE

45. **THE H. SHOESMITH TROPHY**
Holder: Harry Godden
- One Vase of Incurved Chrysanthemums. (Section 3).**
Large or Medium flowered, and
One Vase of Reflexed or Intermediate Chrysanthemums. (Sections 4 or 5).
Large or Medium flowered, disbudded, five blooms of one cultivar in each vase.
Trophy, Silver Medal

SINGLES

46. **The Member winning this class will be acknowledged**
“NATIONAL CHAMPION FOR LATE LARGE SINGLE CHRYSANTHEMUMS”
and will be awarded
THE GEORGE MONRO CHALLENGE CUP
Holder: Keith Atkinson
- Five Vases of Singles, Large flowered. (Section 7).**
Five distinct cultivars, disbudded, five blooms of one cultivar in each vase.
Cup, Solid Silver Medal
47. **THE ROBERTSON CHALLENGE TROPHY**
Holder: Phillip Hall
- Three Vases of Singles, Large flowered. (Section 7).**
Three distinct cultivars, disbudded, five blooms of one cultivar in each vase.
Trophy, Silver Medal
48. **One Vase of Singles, Large flowered. (Section 7).**
Any cultivar or cultivars, disbudded, five blooms.
49. **The Member winning this class will be acknowledged the**
“NATIONAL CHAMPION FOR LATE MEDIUM SINGLE CHRYSANTHEMUMS”
and will be awarded:
THE GEORGE W. TARRY PERPETUAL TROPHY
Presented by George W. Tarry
Holder: Allen Munday
- Five Vases of Singles, Medium flowered. (Section 7).** Five distinct cultivars,
disbudded, five blooms of one cultivar in each vase. **Trophy, Solid Silver Medal**

SEPTEMBER SHOW

Class for 2017 Novelties

The following class is for Novelties available for the first time to the general public in the 2017 season. An exhibitor may stage more than one entry from each section provided each vase contains a distinct cultivar.

14. **One Vase of Early Chrysanthemums, any 2017 release.** (as in the Society’s Spring and Summer Bulletins). Three blooms of one cultivar, disbudded, or three “Exhibition” sprays.

LARGE FLOWERED

15. **The Member winning this class will be acknowledged**
“NATIONAL CHAMPION FOR LARGE EARLY CHRYSANTHEMUMS”
and will be awarded:
THE BERTRAM F. JONES PERPETUAL CHALLENGE TROPHY
Holder: Graham Barclay
Nine Vases of Early Chrysanthemums. (Section 23, and/or 24, and/or 25).
Large flowered, Seven distinct cultivars, disbudded, five blooms of one cultivar in each vase.
No more than Two vases of One Cultivar.
Trophy, Solid Silver Medal
16. **THE JOHNSON PERPETUAL CHALLENGE TROPHY**
Presented by Messrs. J. and T. Johnson
Holder: Fred Waining
- Six Vases of Early Chrysanthemums. (Section 23, and/or 24, and/or 25).**
Large flowered, six distinct cultivars, disbudded, five blooms of one cultivar in each vase.
Trophy, Silver Medal
17. **THE BRENDAN POLLARD PERPETUAL TROPHY**
Holder: Fred Swabey
- Three Vases of Early Chrysanthemums. (Section 23, and/or 24, and/or 25).**
Large-flowered, three distinct cultivars, disbudded, five blooms of one cultivar in each vase.
Trophy, Silver Medal
18. **One Vase of Early Chrysanthemums. Incurved. (Section 23).**
Large flowered, one cultivar only, disbudded, five blooms.
19. **One Vase of Early Chrysanthemums. Reflexed or Intermediate. (Section 24 or 25).**
Large flowered, one cultivar only, disbudded, five blooms.
20. **One Vase of Early Chrysanthemums. (Section 23, and/or 24, and/or 25).**
Large flowered, not fewer than two cultivars, disbudded, five blooms.

SEPTEMBER SHOW

MEDIUM FLOWERED

21. **The Member winning this class will be acknowledged**
“NATIONAL CHAMPION FOR MEDIUM EARLY CHRYSANTHEMUMS”
and will be awarded:
THE CLAY PERPETUAL CHALLENGE CUP
Holder: John & Allyson Peace
- Nine Vases of Early Chrysanthemums. (Section 23, and/or 24, and/or 25).**
Medium flowered, Seven distinct cultivars, disbudded, five blooms of one cultivar in each vase. No more than Two vases of One Cultivar
Cup, Solid Silver Medal
22. **THE CRICK PERPETUAL CHALLENGE CUP**
Holder: Jim Fenion
- Six Vases of Early Chrysanthemums. (Sections 23, and/or 24, and/or 25).**
Medium flowered, six distinct cultivars, disbudded, five blooms of one cultivar in each vase.
Cup, Silver Medal
23. **THE MEDIUM CHALLENGE CUP**
Presented by John Perrott
Holder: David Groves
- Three Vases of Early Chrysanthemums. (Section 23, and/or 24, and/or 25).**
Medium flowered, three distinct cultivars, disbudded, five blooms of one cultivar in each vase.
Cup, Silver Medal
24. **SYD PAINE TROPHY**
Holder: Ian Martin
- Three Vases of Early Chrysanthemums. Incurved and/or Intermediate. (Sections 23 and/or 25).** Medium flowered, three distinct cultivars, disbudded, five blooms of one cultivar in each vase.
Vase, Silver Medal
25. **One Vase of Early Chrysanthemums. Incurved. (Section 23).**
Medium flowered, one cultivar only, disbudded, five blooms.
26. **One Vase of Early Chrysanthemums. Reflexed. (Section 24).**
Medium flowered, one cultivar only, disbudded, five blooms.
27. **One Vase of Early Chrysanthemums. Intermediate. (Section 25).**
Medium flowered, one cultivar only, disbudded, five blooms.
28. **One Vase of Early Chrysanthemums. (Section 23, and/or 24, and/or 25).**
Medium flowered, not less than two cultivars, disbudded, five blooms.

NOVEMBER SHOW

33. **One Vase of Incurved Chrysanthemums. (Section 3).**
One cultivar disbudded, five blooms.
- 34 **One Vase of Incurved Chrysanthemums. (Sections 3).**
No fewer than two distinct cultivars, disbudded, five blooms.

REFLEXED AND INTERMEDIATE

35. **The Member winning this class will be acknowledged**
“NATIONAL CHAMPION FOR LATE REFLEXED AND INTERMEDIATE CHRYSANTHEMUMS”
and will be awarded:
THE GEORGE PRICKETT CHALLENGE TROPHY
Holder: John & Allyson Peace
- Five Vases of Reflexed and/or Intermediate Chrysanthemums. (Section 4, and/or 5).**
Five distinct cultivars, disbudded, five blooms of one cultivar in each vase.
Trophy, Solid Silver Medal
36. **THE CHARLES LUCKIN CHALLENGE TROPHY**
Holder: Bill Croft
- Five Vases of Reflexed and/or Intermediate Chrysanthemums. (Section 4, and/or 5).**
Large and/or Medium and/or Small flowered, five distinct cultivars, disbudded, three blooms of one cultivar in each vase
Trophy, Silver Medal
37. **THE LEVINGTON TROPHY**
Holder: Bill Croft
- Three Vases of Large Reflexed and/or Large Intermediate Chrysanthemums. (Section 4, and/or 5).** Three distinct cultivars, disbudded, five blooms of one cultivar in each vase.
Trophy, Silver Medal
38. **THE THOMAS WARRINGTON PERPETUAL TROPHY**
Holder: Steve & Stella Joyce
- Three Vases of Medium Reflexed and/or Medium Intermediate Chrysanthemums. (Section 4, and/or 5).** Three distinct cultivars, disbudded, five blooms of one cultivar in each vase.
Trophy, Silver Medal
39. **THE BILL HOLLAND TROPHY**
Holder: Steve & Stella Joyce
- Three Vases of Reflexed and/or Intermediate Chrysanthemums. (Section 4, and/or 5).**
Large and/or Medium flowered, three distinct cultivars, disbudded, three blooms of one cultivar in each vase.
Trophy, Silver Medal
40. **THE CHRYSANTHEMUM DIRECT TROPHY**
Presented by Chrysanthemums Direct
Holder: John Marshall
- Three Vases of Reflexed and/or Intermediate Chrysanthemums. (Section 4, and/or 5).**
Large and/or Medium flowered, three distinct cultivars, disbudded, five blooms of one cultivar in each vase. At least one Vase large and one vase medium.
Trophy, Silver Medal

NOVEMBER SHOW
LARGE and MEDIUM EXHIBITION

26. **THE JAP TROPHY**
Holder: Brian Sidebottom
- Nine Large and Medium Exhibition Blooms.**
Not more than five Blooms of Large or five blooms of Medium Exhibition .
At least two cultivars Large and two cultivars Medium Exhibition blooms.
Trophy, Silver Medal

THE MIXED JAP TROPHY
Holder: Brian Sidebottom

- Six Large and Medium Exhibition Blooms.**
Minimum of Two Blooms of Large & Two blooms of Medium Exhibition .
At least three distinct cultivars .
Trophy, Silver Medal

INCURVED

28. **The Member winning this class will be acknowledged**
“NATIONAL CHAMPION FOR LATE INCURVED CHRYSANTHEMUMS”
and will be awarded:
THE HOLMES MEMORIAL CHALLENGE CUP
Holder: Harry Godden
- Five Vases of Incurved Chrysanthemums. (Section 3).**
Large and/or Medium flowered, five distinct cultivars, disbudded, five blooms of one cultivar in each vase
Cup, Solid Silver Medal
29. **THE GEORGE AND GLADYS HUGHES PERPETUAL TROPHY**
Holder: Harry Godden
- Five Vases of Incurved Chrysanthemums. (Section 3).**
Large and/or Medium flowered, not less than three distinct cultivars, disbudded, three blooms of one cultivar in each vase.
Trophy, Silver Medal
30. **THE TED WHITTOCK MEMORIAL TROPHY**
Presented by Mrs D. Whittock
Holder: Harry Godden
- Three Vases of Incurved Chrysanthemums. (Sections 3).**
Large and/or Medium flowered, three distinct cultivars, disbudded, five blooms of one cultivar in each vase.
Trophy, Silver Medal
31. **THE H. HATTON MEMORIAL TROPHY**
Presented by Dean Law
Holder: Harry Godden
- Three Vases of Incurved Chrysanthemums. (Sections 3).**
Large and/or Medium flowered, three distinct cultivars, disbudded, three blooms of one cultivar in each vase.
Trophy, Silver Medal
- 32 **Two Vases of Incurved Chrysanthemums. (Section 3).**
Large and/or Medium flowered, two distinct cultivars, disbudded, five blooms of one cultivar in each vase.

SEPTEMBER SHOW
LARGE AND MEDIUM FLOWERED

29. **The Member winning this class will be acknowledged**
“NATIONAL CHAMPION FOR LARGE/MEDIUM EARLY CHRYSANTHEMUMS”
and will be awarded:
THE BOB DAWSEY MEMORIAL TROPHY
Holder: John & Allyson Peace
- Nine Vases of Early Large and Medium Chrysanthemums, from Sections 23, 24, 25.**
All sections to be used, at least 1 vase Large, 1 vase Medium, Nine distinct cultivars, disbudded, five blooms of one cultivar in each vase.
Trophy, Solid Silver Medal
30. **THE JOHN PEACE Snr MEMORIAL TROPHY**
Presented by Sunderland Chrysanthemum Society
Holder: Frankie Charlton
- Six Vases of Early Large and Medium Chrysanthemums, from Sections 23, 24, 25.**
All sections to be used, at least 1 vase Large, 1 vase Medium, six distinct cultivars, disbudded, five blooms of one cultivar in each vase.
Trophy, Silver Medal
31. **THE BILL WADE MEMORIAL TROPHY**
Holder: Malcolm & Audrey Simpson
- Six Vases of Early Large and/ or Medium Intermediate Chrysanthemums, Section 25,** six distinct cultivars, disbudded, five blooms of one cultivar in each vase.
Trophy, Silver Medal
32. **THE INTERMEDIATE CHALLENGE SHIELD**
Holder: Ian Martin
- Three Vases of Early Large and/ or Medium Intermediate Chrysanthemums, Section 25,** three distinct cultivars, disbudded, five blooms of one cultivar in each vase.
Trophy, Silver Medal
33. **THE TOM JONES PIECE OF PLATE**
Holder: Ian Martin
- Three Vases of Early Chrysanthemums. (Section 23, and/or 24, and/or 25).**
Large and/or Medium flowered, three distinct cultivars, disbudded, five blooms of one cultivar in each vase. At least one vase of Large and one vase Medium.
Piece of Plate, Silver Medal
34. **THE JACK OLDHAM MEMORIAL TROPHY**
Holder: George Proverbs
- Five Vases of Early Chrysanthemums. (Section 23, and/or 24, and/or 25).**
Large and/or Medium flowered. five distinct cultivars, disbudded, three blooms of one cultivar in each vase, five distinct colours, only 1 from each of the 21 colour classifications.
Trophy, Silver Medal

SEPTEMBER SHOW

THE H HATTON MEMORIAL JUG

Presented by Dean Law & Family

New Trophy:

- 35 **Five Vases of Early Chrysanthemums. (Section 23, and/or 24, and/or 25).**
Large and/or Medium flowered. five distinct cultivars, disbudded, three blooms of one cultivar in each vase. . At least 1 vase Large, 1 vase Medium

Trophy, Silver Medal

SMALL FLOWERED

(“c” Cultivars as listed in 2011 Register supplement)

- 36 **Three vases “c” cultivars,** Five blooms per vase, a distinct Cultivar per vase, at least two distinct cultivars.

Trophy, Silver Medal

- 37 **Three vases “c” cultivars,** Three blooms per vase, a distinct Cultivar per vase, at least two distinct cultivars.

Trophy, Silver Medal

38. **THE RUSHTON PERPETUAL TROPHY**

Presented by C Rushton

Holder: Ian Martin

Two Vases of Early Chrysanthemums. (Sections 23, and/or 24, and/or 25).
One vase of Large flowered, one vase of Medium flowered, disbudded, five blooms of one cultivar in each vase.

Trophy, Silver Medal

INCURVE CHRYSANTHEMUMS

39. **THE WESTERN GROUP TROPHY**

Holder: Ken Mc Dean

Three Vases of Early Chrysanthemums. (Section 23).
Large and/or Medium flowered, three distinct cultivars, disbudded, five blooms of one cultivar in each vase.

Trophy, Silver Medal

SPRAY CHRYSANTHEMUMS

40. **The Member winning this class will be acknowledged
“NATIONAL CHAMPION FOR EARLY SPRAY CHRYSANTHEMUMS”
and will be awarded:**

THE HAROLD WALKER MEMORIAL TROPHY

Holder: Joe Jenkins

Nine Vases of Early Spray Chrysanthemums. (Section 29).
Nine distinct cultivars, five ‘Exhibition’ sprays of one cultivar in each vase.

Trophy, Solid Silver Medal

41. **THE GEORGE BARKER PERPETUAL TROPHY**

Holder: Kenneth Fowler

Six Vases of Early Spray Chrysanthemums. (Section 29).
Six distinct cultivars, five ‘Exhibition’ sprays of one cultivar in each vase.

Trophy, Silver Medal

NOVEMBER SHOW

MEDIUM EXHIBITION

20. **The Member winning this class will be acknowledged
“NATIONAL CHAMPION FOR MEDIUM EXHIBITION CHRYSANTHEMUMS”
and will be awarded:**

THE T. F. PATTISON PERPETUAL TROPHY

Holder: Dave Arnall

Eighteen Medium Exhibition Blooms. (Section 2).
Not fewer than nine distinct cultivars and not more than four blooms of one cultivar,
eighteen vases, one bloom in each vase. **Trophy, Solid Silver Medal**

21

**THE W. H. JARRATT TROPHY
Presented by Leicester Chrysanthemum Society**

Holder: Roger Brownbridge

Twelve Medium Exhibition Blooms. (Section 2).
Not fewer than seven distinct cultivars and not more than four blooms of one cultivar,
twelve vases, one bloom in each vase. **Trophy, Silver Medal**

22. **THE MEDIUM EXHIBITION PERPETUAL TROPHY**

Presented by Dorothy and Stanley Gosling

Holder: Terry Fry

Nine Medium Exhibition Blooms. (Section 2).
Not fewer than five distinct cultivars, nine vases, and not more than four blooms of one
Cultivar, one bloom in each vase.

Trophy, Silver Medal

23. **THE NEAL PERPETUAL TROPHY**

Holder: Ken Dear

Six Medium Exhibition Blooms. (Section 2).
Not fewer than three distinct cultivars, six vases, one bloom in each vase.
Trophy, Silver Medal

24. **THE REG WALLER TROPHY**

Holder : Michael Potts

Three Medium Exhibitions Blooms. (Section2).
Three vases, any cultivar or cultivars, one bloom in each vase. **Trophy, Silver Medal**

25. **One Medium Exhibition Bloom. (Section 2).**

Any cultivar.

NOVEMBER SHOW

LARGE EXHIBITION

14. **The Member winning this class will be acknowledged
“NATIONAL CHAMPION FOR LARGE EXHIBITION CHRYSANTHEMUMS”
and will be awarded:
THE CENTENARY TROPHY
Presented to the National Chrysanthemum Society
by Frank Dodson, former President of the Society
Holder: Andy Wickham**

Eighteen Large Exhibition Blooms. (Section 1).
Not fewer than nine distinct cultivars and not more than four blooms of one cultivar,
eighteen vases, one bloom in each vase. **Trophy, Solid Silver Medal**

15. **THE HOLMES MEMORIAL TROPHY CHALLENGE CUP
Holder: Ivor Mace**

Twelve Large Exhibition Blooms. (Section 1).
Not fewer than seven distinct cultivars and not more than four blooms of one cultivar,
twelve vases, one bloom in each vase. **Cup, Silver Medal**

16. **THE KEITH LUXFORD CHALLENGE CUP
Holder: John Williams**

Nine Large Exhibition Blooms. (Section 1).
Not fewer than five distinct cultivars, nine vases, and not more than four blooms of one
Cultivar, one bloom in each vase. **Cup, Silver Medal**

17. **THE J. H. GODDARD CHALLENGE CUP
Holder: Barry Cundiff**

Six Large Exhibition Blooms. (Section 1).
Not fewer than three distinct cultivars, six vases, one bloom in each vase. **Cup, Silver Medal**

18. **THE RICHARDSON CHALLENGE CUP
Holder: Ivor Mace**

Three Large Exhibition Blooms. (Section 1).
Three vases, any cultivar or cultivars, one bloom in each vase. **Cup, Silver Medal**

19. **One Large Exhibition Bloom. (Section 1).**
Any cultivar.

SEPTEMBER SHOW

42. **THE CORBY SOCIETY PERPETUAL TROPHY
Holder: Peter Gibbons**

Three Vases of Early Spray Chrysanthemums. (Section 29).
Three distinct cultivars, five ‘Natural’ or ‘Exhibition’ sprays of one cultivar in each vase.
Trophy, Silver Medal

43. **THE TERRY BROOK MEMORIAL TROPHY
Holder: Peter Gibbons**

Three Vases of Early Double Spray Chrysanthemums. (Section 29, sub-sections b, c, e).
Three distinct cultivars, five ‘Exhibition’ sprays of one cultivar in each vase.
Trophy, Silver Medal

44. **One Vase of Early Double Spray Chrysanthemums. (Section 29, sub-sections b, c, e).**
Five ‘Exhibition’ sprays, any cultivar or cultivars.

45. **Three Vases of Early Single Spray Chrysanthemums. (Section 29, sub-sections
a, d, f).** Three distinct cultivars, five ‘Exhibition’ sprays of one cultivar in each vase.

46. **One Vase of Early Single Spray Chrysanthemums. (Section 29, sub-sections
a, d, f).** Five ‘Exhibition’ sprays, any cultivar or cultivars.

47. **Three Vases of Early Spray Chrysanthemums. (Section 29).**
Three distinct cultivars, five “Natural” sprays of one cultivar in each vase.

48. **One Vase of Early Spray Chrysanthemums. (Sections 29).**
Five “Natural” sprays, any cultivar or cultivars.

49. **One Vase of Early Spray Chrysanthemums. (Sections 29).**
Five ‘Natural’ or ‘Exhibition’ sprays, any cultivar or cultivars.

INDIVIDUAL CHAMPIONSHIP

50. **THE KEN COOPER MEMORIAL TROPHY
Holder: John & Allyson Peace**

**Four Vases of Early Chrysanthemums. (One Vase from each of the following Sections:
23, 24, 25 and 29).** Each vase to contain five blooms, disbudded, or five ‘Exhibition’ sprays,
one cultivar in each vase. **Trophy, Solid Silver Medal**

*These classes are for those who employ no paid assistance in the culture of their
Chrysanthemums and grow not more than 100 early-flowering plants (excluding sprays).*

51. **THE JIMMY DRAYCOTT MEMORIAL TROPHY
Presented by Eileen Draycott
Holder: Roger Collier**

Three Vases of Early Chrysanthemums. (Section 23, and/or 24, and/or 25).
Large and/or Medium and/or Small flowered, three distinct cultivars, disbudded, three blooms of
one cultivar in each vase. **Trophy, Silver Medal**

SEPTEMBER SHOW

- 52. One Vase of Early Chrysanthemums. (Section 23, or 24, or 25).**
Large flowered, one cultivar, disbudded, three blooms.
- 53. One Vase of Early Chrysanthemums. (Section 23, and/or 24, and/or 25).**
Large flowered, not fewer than two cultivars, disbudded, five blooms.
- 54. One Vase of Early Chrysanthemums. (Section 23 or 24 or 25).**
Medium or Small flowered, one cultivar disbudded, three blooms.
- 55. One Vase of Early Chrysanthemums. (Section 23, and/or 24, and/or 25).**
Medium and/or Small flowered, not fewer than two cultivars, disbudded, five blooms.

Class 56 is restricted to those who have not previously won a first prize in a multi-vase class at the Early Show of the National Chrysanthemum Society. See Rule 20

56. E. T. THISTLETHWAITE PERPETUAL TROPHY
Holder: Lauren Postins

Three Vases of Early Chrysanthemums. (Sections 23, and/or 24, and/or 25). Large, and/or Medium and/or Small flowered, three distinct cultivars, disbudded, five blooms of one cultivar in each vase.
Trophy, Silver Medal

Classes 57 to 64 are restricted to those who have not previously won a first prize at the Early Show of the National Chrysanthemum Society.

- 57. One Vase of Early Chrysanthemums. (Section 23).**
One cultivar disbudded, five blooms.
- 58. One Vase of Early Chrysanthemums. (Section 24).**
One cultivar, disbudded, five blooms.
- 59. One Vase of Early Chrysanthemums. (Section 25).**
One cultivar, disbudded, five blooms.
- 60. One Vase of Early Chrysanthemums. (Section 23, or 24, or 25).**
Large flowered. one cultivar disbudded, five blooms.
- 61. One Vase of Early Chrysanthemums. (Section 23, or 24, or 25).**
Medium or Small flowered. one cultivar, disbudded, five blooms.
- 62. One Vase of Early Chrysanthemums. (Section 23, and/or 24, and/or 25).**
Not fewer than two cultivars, disbudded, five blooms.
- 63. Three Vases of Early Spray Chrysanthemums. (Section 29).**
Three distinct cultivars, three 'Natural' or 'Exhibition' sprays of one cultivar in each vase.
- 64. One Vase of Early Spray Chrysanthemums. (Section 29).**
Three 'Natural' or Exhibition' sprays, any cultivar or cultivars.

NOVEMBER SHOW

RAISERS' CLASSES

Competitive Classes for Seedling Chrysanthemums
SPORTS ARE NOT ELIGIBLE

Classes 11 and 12 are open to all raisers to stage exhibits of cultivars which have been registered and classified and which have not yet been released for sale to the public. There is no limit to the number of entries made by each exhibitor in either class. No exhibitor may stage more than one entry of any cultivar, and no cultivar may win the Trophy more than once.

CHRYSANTHEMUM RAISERS' ASSOCIATION PERPETUAL TROPHY
FOR THE BEST EXHIBIT IN CLASSES 11 & 12
Holder: John Nevill

- 11. One Vase of October or Late Chrysanthemums. (Sections 1 – 8 , 10 – 11 and 13 - 18).**
Sections 1, 2 and 16 to be staged one bloom to a vase.
Sections 3 – 8, 10, 11, 13 - 15 and 17, 18, three blooms of one cultivar, staged in one vase.
Silver Medal
- 12. One Vase of Late Chrysanthemums in Spray form. (Sections 9 or 19).**
Three 'Exhibition' sprays of one cultivar.

Silver Medal

Class for 2017 Novelties

The following class is for Novelties available for the first time to the general public in the 2016 season. An exhibitor may stage more than one entry from each section provided each vase contains a distinct cultivar.

- 13. One Vase of Late Chrysanthemums any 2017 release** (as listed in the Society's Spring and Summer Bulletins) from any of the following sections:
One Large Exhibition bloom, or One Medium Exhibition bloom,
Three Incurved blooms, one cultivar, disbudded, staged in one vase,
Three Reflexed blooms, one cultivar, disbudded, staged in one vase,
Three Intermediate blooms, one cultivar, disbudded, staged in one vase,
Three Anemone blooms, one cultivar, disbudded, staged in one vase,
Three Single blooms, one cultivar, disbudded, staged in one vase,
Three 'Exhibition' Sprays, one cultivar, staged in one vase.

NOVEMBER SHOW

4. **Three Large Exhibitions Blooms. (Section 1).**
Three vases, one bloom in each vase, any cultivar or cultivars.
5. **Three Medium Exhibition Blooms. (Section 2).**
Three vases, one bloom in each vase, any cultivar or cultivars.
6. **Three Vases of Late Spray Chrysanthemums. (Section 9).**
Three distinct cultivars, three 'Exhibition' sprays of one cultivar in each vase.
7. **One Large or Medium Exhibition Bloom. (Section 1 or 2).**
Any cultivar.
8. **One Vase of Late Chrysanthemums.**
Five blooms, disbudded; any cultivar or cultivars from any one of Sections 3, 4, 5, 6 or 7.

AFFILIATED SOCIETIES' LEAGUE CLASS'S

9. **NORTH WEST COUNTIES TROPHY**
Holder: Chester & District Society
Back row, 2 blooms, Large and/or Medium Exhibition (Sections 1 and/or 2)
Middle row, 2 blooms, Large and/or Medium flowering, Reflexed and/or Intermediate (Sections 4, 5)
Front row, 2 blooms, Large, and/or Medium flowering, Incurved (Section 3).
Trophy
10. **AFFILIATED SOCIETY CHALLENGE SHIELD**
Holder:
Back row, 2 Vases, two blooms, one bloom per vase ,both blooms from same section
Middle row, 2 Vases, two blooms, one bloom per vase ,both blooms from same section
Front row, 2 Vases, two blooms, one bloom per vase ,both blooms from same section
Two blooms are required from each of three different sections from 3,4,5,6,7 or 9.
Trophy

EACH BLOOM STAGED IN A SEPARATE VASE WITH 660 mm MAXIMUM HEIGHT FROM STAGING TO TOP OF BLOOM. These classes will be judged on a strict points system, each bloom individually pointed **SEE RULE 15.**

The National Chrysanthemum Society will award Medals as follows:

Class 9 for the Best Large/Medium Exhibition Bloom, the Best Intermediate or Reflex Bloom, and the Best Incurve Bloom.

Class 10 for the Best bloom from each of the sections staged.

SEPTEMBER SHOW

CLASSES OPEN TO ALL

- 65 **One Vase of Early Chrysanthemums. (Section 27).**
One cultivar, disbudded, five blooms.

OLD CULTIVAR CLASSES

66. **OLD CULTIVAR TROPHY**
Holder:
Three vases of Early Chrysanthemums.
3 Blooms disbudded per vase.
Trophy, Silver Medal
67. **One Vase of Early Chrysanthemums,**
5 blooms disbudded .
Cultivars eligible to be shown: Those registered before 1980 and not shown at a National show in past five years. Some cultivars that can also be shown, even though odd vases may have been shown in past five years are Cricket, Tracy Waller and sports, Keystone, Sam Oldham, Gladys Sharpe, Martina, Fiona Lynn.

INDIVIDUAL SINGLE BLOOM CHAMPIONSHIP

- 68 **Single Bloom Championship**
Holder: Malcolm & Audrey Simpson
Six vases, one bloom per vase.
Each vase to hold one bloom from sections 23, 24,25,26,27 or 29. Six distinct cultivars, from a minimum 3 sections.
Trophy, Silver Medal

INDIVIDUAL SINGLE BLOOM TROPHY

- 69 **Holder: Brian Sidebottom**
Six vases, one bloom per vase.
Any cultivar or cultivars from sections 23, 24,25,26,27 or 29.
Trophy, Silver Medal

TRAVELLERS CLASS

Entries in these classes will be accepted up to 9.30 am on morning of show. Obtain the appropriate class cards from the Show Manager. More than one entry allowed.

- 70 **One Vase of Early Chrysanthemums.**
Five blooms disbudded, any cultivar or cultivars.
- 71 **One Vase of Early Spray Chrysanthemums.**
Five 'Natural' or 'Exhibition' sprays, any cultivar or cultivars.

NOVEMBER SHOW

NATIONAL CHRYSANTHEMUM SOCIETY
THE EXHIBITION OF

LATE CHRYSANTHEMUMS

SPECIAL AWARDS

The Bentley Trophy – *Holder:* Steve & Stella Joyce - and a Solid Silver medal will be awarded to the exhibit of most merit in the show, together with a cut glass trophy.

The Stanley Gosling Memorial Perpetual Trophy – *Holder:* Steve & Stella Joyce - will be awarded to the Best Vase of blooms in the show.

A Solid Silver Medal will be awarded to the best Large Exhibition bloom in the Show.

A Solid Silver Medal will be awarded to the best Medium Exhibition bloom in the Show.

A Solid Silver Medal will be awarded to the best vase of Incurved blooms in the Show.

The Wallace Brook Trophy will be awarded to the best Large or Medium Exhibition bloom in the Show. *Holder:* Andy Wichham

The Darren Pugh Memorial Trophy will be awarded to the Best Vase of Incurved blooms in Show. *Holder:* Ron & Margaret Jones

The Elsie & Larry Barlow Memorial trophy will be awarded to the best Medium Exhibition bloom in the show. *Holder:* Dave Arnall

The Arthur Munday Trophy will be awarded to the Best Fantasy bloom in Show.

Holder: Brian Sidebottom

The Harry Lawson Memorial Trophy will be awarded for the best vase of Medium Singles in the show. *Holder:* Steve & Stella Joyce

A Solid Silver Salver will be awarded to the best vase of Reflexed or Intermediate blooms in the Show. *Holder:* Steve & Stella Joyce

A Solid Silver Medal will be awarded to the best vase of Large Reflexed blooms in the Show.

A Solid Silver Medal will be awarded to the best vase of Medium Reflexed blooms in the Show.

A Solid Silver Medal will be awarded to the best vase of Large Intermediate blooms in the Show.

A Solid Silver Medal will be awarded to the best vase of Medium Intermediate blooms in the Show.

A Solid Silver Medal will be awarded to the best vase of Large Singles in the Show.

A Solid Silver Medal will be awarded to the best vase of Medium Singles in the Show.

A Solid Silver Medal will be awarded to the best vase of Anemones in the Show.

A Solid Silver Medal will be awarded to the best vase of Fantasies in the Show.

Spray Awards

There will be a best vase of Sprays chosen from sub-sections (a), (d) or (f).

There will be a best vase of Sprays chosen from sub-section (b), (c) or (e).

The overall best vase of Sprays will be awarded the Philip Rowe Solid Silver Medal, the other vase will be awarded a N.C.S. Solid Silver Medal.

NOVEMBER SHOW AFFILIATED SOCIETY CLASSES

1. **AFFILIATED SOCIETIES' CHAMPIONSHIP OF GREAT BRITAIN**
The winner of this class will be acknowledged
NATIONAL CHRYSANTHEMUM SOCIETY AFFILIATED SOCIETIES CHAMPIONS
and will be awarded:

THE UNIQUE CHALLENGE TROPHY
Presented to the National Chrysanthemum Society by
J. J. Ward, former President of the Society
Holder: Swansea Chrysanthemum Society

An Exhibit of Late Chrysanthemums (Seven Vases).

Three vases of Large Exhibition (Section 1) and/or Medium Exhibition (Section 2) one bloom in each vase, any cultivar or cultivars, and

Four vases from the following. Note four different sections must be shown.

One distinct cultivar to a vase.

One vase of five blooms Incurved (Sections 3, disbudded).

One vase of five blooms Reflexed (Sections 4 disbudded).

One vase of five blooms Intermediate (Sections 5 disbudded).

One vase of five blooms Anemone (Section 6 disbudded).

One vase of five blooms Singles (Sections 7 disbudded).

One vase of three stems Sprays (Section 9 Exhibition).

Judging Note: Intermediate, Incurved, Reflexed, Anemone and Singles to be valued at a maximum of 100 points per vase. 3 Large Exhibition and/or Medium Exhibition blooms in single vases treat as one unit, maximum of 100 points. **Trophy, Silver Medals**

2. **FRANCIS PARRY SOLID SILVER SALVER**
Holder: Swansea Chrysanthemum Society

An Exhibit of Late Chrysanthemums (Five vases).

One vase Large Exhibition (Section 1) or one vase Medium Exhibition (Section 2) one bloom in each vase, and

Four vases from the following. Note four different sections must be shown.

One distinct cultivar to a vase.

One vase of three blooms Incurved (Section 3 disbudded).

One vase of three blooms Reflexed (Section 4 disbudded).

One vase of three blooms Intermediate (Section 5 disbudded).

One vase of three blooms Anemone (Section 6 disbudded).

One vase of three blooms Singles (Section 7 disbudded).

One vase of three stems Sprays (Section 9 Exhibition).

Salver, Silver Medals

Class 1 & 2 See rule 14 re Additional Silver medals.

3. **THE CLARENCE CHALLENGE TROPHY**
Presented by Weston Chrysanthemum Society
Holder: Not Awarded

Three Vases of Late Chrysanthemums.

To consist of (1) One vase of Incurved (Section 3).

(2) One vase of Reflexed (Section 4) or Intermediate (Section 5).

(3) One vase of Anemones (Sections 6) or Singles (Section 7).

Five blooms in each vase, disbudded, any cultivar or cultivars.

Trophy, Silver Medals